

Mirror Mover Kit for Jeep Wrangler '97-'02 (TJ)

Installation and Instruction Manual
#13025.1102



CAUTION

READ ALL SAFETY MESSAGES AND UNDERSTAND ALL INSTRUCTIONS AND PROCEDURE NOTICES BEFORE ATTEMPTING TO INSTALL OR USE THIS PRODUCT.

KIT CONTENTS LIST:

Mirror Relocation Brackets:
Passenger Side (1)
Driver Side (1)
Adjustable Door Check Straps (2)

A. Hex Button Head Cap Screws:
1/4 - 20 x 3/8 (6)

B. Hex Button Head Cap Screws:
5/16 - 18 X 1 (4)

C. Bracket Inserts (2)

D. Nylock Nuts (2)

E. Washers (2)

F. Cup Washers (2)

REQUIRED TOOLS:

Safety Glasses
T20 Torx Screwdriver
For Door Check Strap Footman Loop Removal
T27 Torx Socket 1/4" Drive
For Mirror Bolts Removal
T40 Torx Socket 3/8" Driver
For Removal Of Windshield Bracket Bolts
5/32" Hex Key
For Installing New Mirror Hardware And
Button Head Cap Screws
3/16" Hex Key
For Installing New Windshield Bracket Bolts
1/4" Drive Ratchet & Extension
3/8" Drive Ratchet
13mm Socket
17mm Socket



The Trusted Source

A Few Words About Product Safety:
Your Mirror Relocation Brackets are intended to enhance the utility and enjoyment of your off road capable vehicle. Before installation, please take a moment to review the following safety

information and installation instructions. Important safety information is generally preceded by one of three signal words indicating the relative risk of injury. The signal words mean:

⚠ WARNING ⚠

a hazardous situation which, if not avoided, could result in death or serious injury. You CAN be KILLED or SERIOUSLY HURT if you don't follow instructions.

⚠ CAUTION ⚠

a hazardous situation which, if not avoided, could result in minor or moderate injury. You CAN be moderately HURT and also may suffer property damage if you don't follow instructions.

NOTICE

Careful attention is required to this instruction or operation but does generally not relate to personal injury. Damage to your Quadratec® product or other property may result if you don't follow instructions.

Before You Begin Installation:

Congratulations on your purchase of Quadratec Mirror Relocation Brackets for your Wrangler TJ. These custom fit brackets have been designed for long life and a great look. Though constructed of only the finest materials, these brackets must be maintained to keep their look while performing under the toughest conditions. Please see page 5 for important care and maintenance tips to keep brackets looking like new.

Thank you again for your purchase and let's start the installation process.

When unpacking, check to make sure all parts are included and not damaged due to shipping. If any part is missing or broken, please call us at Quadratec Customer Service at 800-745-6037 as soon as possible.

⚠ CAUTION ⚠

READ ALL SAFETY MESSAGES AND ALWAYS WEAR SAFETY GLASSES WHEN WORKING WITH TOOLS.

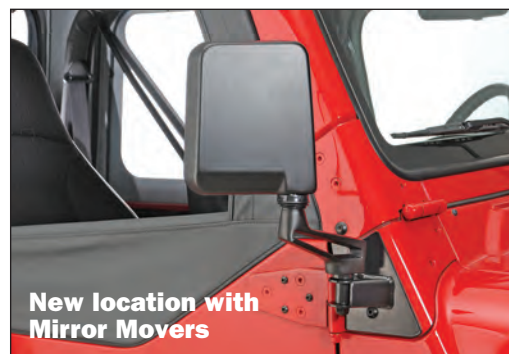

The Trusted Source

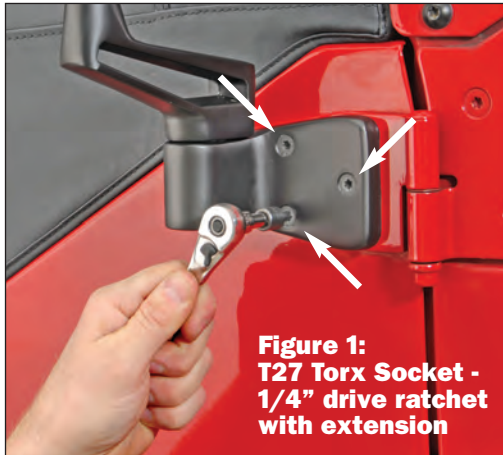

Overview:

Quadratec Mirror Mover Kits are designed to effectively relocate the side view mirrors from the doors to the body of the vehicle known as the "A" pillars. This enables convenient door removal without losing the mirrors. Mirrors are a safety requirement. Never operate a vehicle that does not have adequately installed side view mirrors.

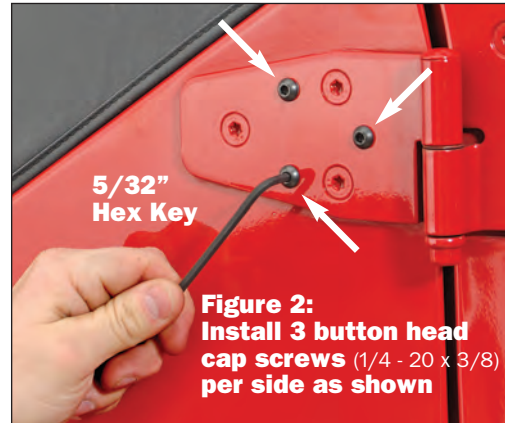

Step One: Mirror Removal

Put on safety glasses. As shown in Figure 1, remove the three Torx screws that attach each mirror to the vehicle using a T27 Torx socket. As shown in Figure 2: Using a 5/32" hex key, install three hex button head cap screws (1/4-20x3/8) into the tapped holes on both sides to keep moisture & debris out and provide a finished look. Paint bolt heads if desired with available touch up paints.



Step Two: Install Adjustable Door Strap

Factory door check straps allow the doors to swing open far enough to come in contact with relocated side view mirrors. By replacing door check straps with the included adjustable versions,



this problem can be eliminated. Figure 3 shows removal of footman loops on the doors using a T20 Torx driver. Next install adjustable check straps. We recommend the 5th slot from the door's footman loop, as shown in figure 4



The Trusted Source

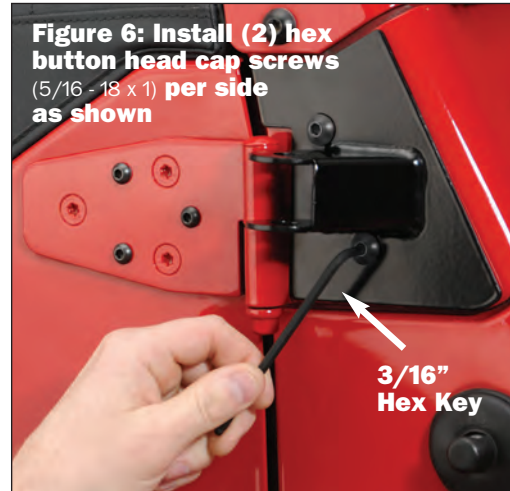
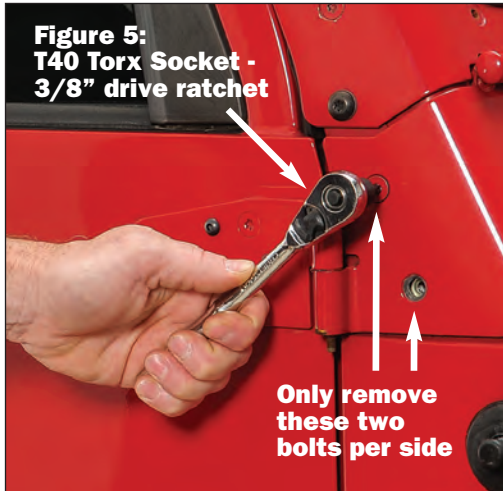

Step Three:

Mirror Relocation Bracket Installation

As shown in Figure 5, remove the two Torx screws shown that attach each windshield frame bracket using a T40 Torx socket. As shown in Figure 6, place appropriate mirror relocation bracket to the correct left or right hand side and

attach each bracket using two hex button head cap screws (5/16-18x1). Using a 3/16" hex head key, tighten each fastener firmly. Re-check for tightness after both fasteners have been installed.

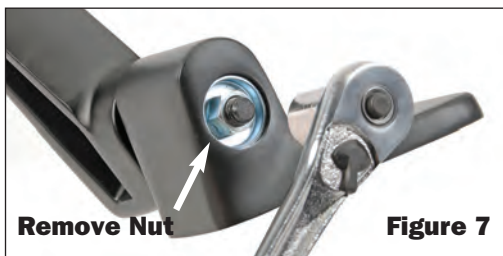

Step Four: Original Mirror Disassembly

As shown in Figure 7, take a mirror and start disassembly using a 13MM Socket to remove the nut from the bottom of the original bracket. Note: Be careful by pointing nut away from you as there is a spring under slight tension in mirror bracket.



As shown in Figure 8, remove nut and slide out mirror. Please note, for the new brackets, you will not reuse the factory spring, cup washer or nut shown. Please set these aside for if you ever restore original mirror bracket to original location.



The Trusted Source

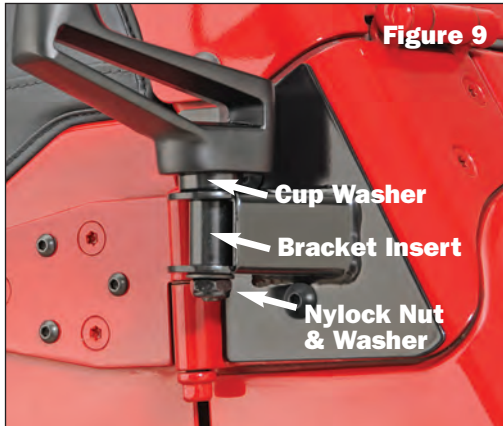

Step Five: Mirror Re-Assembly

As shown in Figure 9, assemble the mirror to bracket using the new, supplied trim cup, spacer, washer and nylock nut into the mirror relocation bracket as shown. Use a 17mm socket to tighten the bolt snugly, taking care not to over tighten. Repeat this step for the opposite side of the vehicle.



Mirror Mover Installation now complete.

Product Care and Maintenance:

Your Mirror Relocation Brackets have been designed and manufactured to provide years of use. However, like any product, general maintenance is required to keep it looking new.

Because the Mirror Relocation Brackets are located on the front of the vehicle, they are subject to potential rock chips and other debris potentially causing portions of the paint to chip off. We recommend using a black spray paint sprayed on a piece of cardboard and Q-Tip to gently fill in these chips. This will prevent any rust from forming.

To further protect your Mirror Relocation Brackets, we recommend using a car wax on the brackets on a regular basis. This will protect the finish and keep them looking like new.

If you have a question specific to your purchase, our customer service staff is standing by. Call us toll free at: **(800) 745-6037** or visit our #1 rated website at **www.quadratec.com**



The Trusted Source

QuadraTop®



Key QuadraTop Features

1. Fabric: Tough 23 ounce mildew and UV resistant vinyl coated polyester and cotton fabric provides lasting durability and is backed by a limited three year warranty. QuadraTops are available in factory original colors and textures to keep your Jeep® looking showroom new!

2. Stitching: Our QuadraTop panels are sewn together with marine grade 135 gauge bonded Anefil® polyester thread that's super strong and UV protected. This rot resistant thread will provide years of worry free durability.

3. Seams: All exposed QuadraTop seams feature heat tape seals over double stitching to keep moisture out.

4. Windows: QuadraTops are available with your choice of zip out crystal clear windows or rear and quarter windows with a dark 31% tint keeping interiors much cooler in hot summer months. Our glass panels are 30mil thick and DOT approved for the ultimate in clarity and durability and feature leak proof heat seals. All windows are completely removable for open air enjoyment.



5. Zippers: QuadraTop window zippers are stitched in place like the original tops and feature jam resistant technology and heavy duty plastic teeth. Side quarter windows feature single metal pulls while the rear glass zippers have user friendly double pulls.

6. Hook & Loop Attachment: Our patterns are fully tested to ensure a tight and wrinkle free fit like the originals. All necessary snaps and Heavy Duty Hook & Loop strips are in place to install over the factory bows and there's never any drilling or modifications required!

7. Belt Rail System: Each QuadraTop utilizes the original belt rail attachment methods for a fit that's as tight as a drum!

8. Upper Door Skins: Our fabric upper doors install in just minutes onto your existing factory upper door frames by hook and loop fastener strips. It's quick and easy with our step by step illustrated instructions. Fabric upper doors have double sided weather strip bulb seals and double window zipper pulls. Note: Wranglers with half steel doors only feature clear upper door windows to meet federal and state requirements.

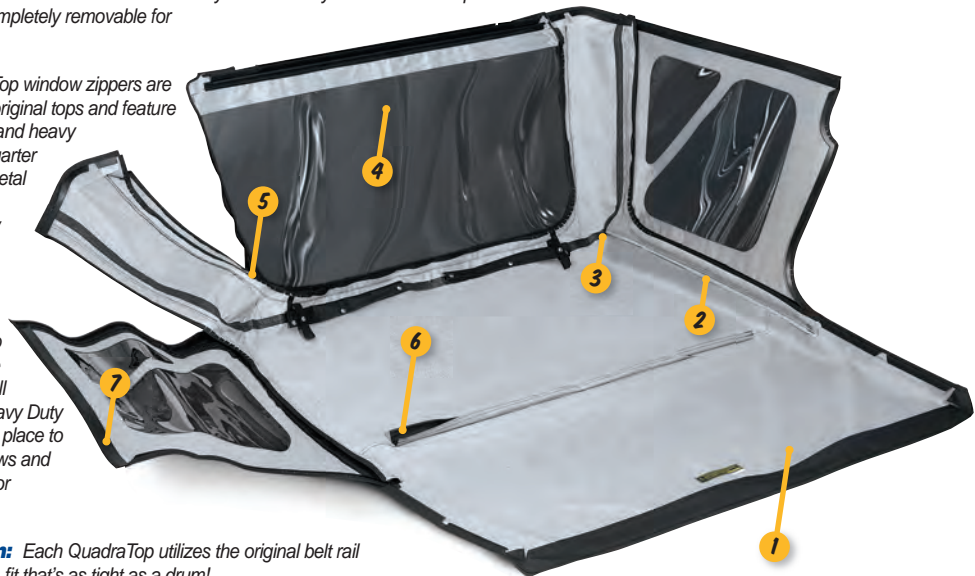

The Trusted Source

QuadraTop® Replacement Soft Tops

Get that New Car Smell along with Affordable quality and durability with no compromises! By partnering with the Exclusive supplier of factory original soft tops on all Jeep Wranglers, we have developed a soft top that delivers the quality and precise fit you want in a replacement top with unsurpassed customer service and support. Our QuadraTop is designed to fit over your original factory soft top hardware system (required*) so installation is easy and quick. Features durable materials and impressive workmanship along with the latest in manufacturing technologies for unprecedented value. QuadraTop is the best value in replacement soft tops compared to other tops costing hundreds more. If for any reason, you are not completely satisfied with your soft top purchase or have an installation question, please contact our professional customer support staff for a solution. All QuadraTops feature a limited three year warranty against defects. The tailored fit and detailed instructions make installation as easy as... **ONE... TWO... THREE!**

Applications for YJ and TJ Wrangler Vehicles:

- For '88-'95 Wrangler w/Upper Doors & Clear Windows #11000.00XX
- For '88-'95 Wrangler w/Upper Doors & Tinted Windows #11000.01XX
- ▶ Colors: 09 · 15 · 17
- For '97-'02 Wrangler w/Clear Windows #11000.02XX
- For '97-'02 Wrangler w/Tinted Windows #11000.03XX
- For '97-'02 Wrangler w/Upper Doors & Clear Windows #11000.04XX
- For '97-'02 Wrangler w/Upper Doors & Tinted Windows #11000.05XX
- ▶ Colors: 15 · 17 · 33
- For '03-'06 Wrangler w/Clear Windows #11000.0635
- For '03-'06 Wrangler w/Tinted Windows #11000.0735
- For '03-'06 Wrangler w/Upper Doors & Clear Windows #11000.0645
- For '03-'06 Wrangler w/Upper Doors & Tinted Windows #11000.0745
- ▶ Colors: 35



**QUADRATOPS
START AT
\$299.99!**

to the RESCUE!

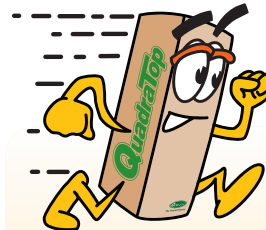

SAME DAY SHIPPING!*

**Factory Trained Soft Top
Advisors Always on Call!**

Go online or call for latest price...



**AFFORDABLE
QUALITY**
WITH NO COMPROMISES!



Due to the limitations of printing, all color samples shown in this catalog are close approximations only.



*Order an In Stock New QuadraTop Soft Top for Delivery in the Lower 48 States Before 4pm Eastern Standard Time, and It'll Ship UPS Ground the Same Day. Ground Shipments take between 1-7 Business Days to Deliver. Need Your Top Faster? Expedited Shipping Options are Available with a UPS Air Freight Surcharge.



The Trusted Source

Quadratec® Exclusive Three Year Limited Warranty

Your Quadratec® branded accessories are covered by the following **Limited Warranty** provided exclusively by Quadratec, Inc., 1028 Saunders Lane, West Chester PA 19380.

This **Limited Warranty** is the only warranty made in connection with your purchase. Quadratec neither assumes nor authorizes any vendor, retailer or other person or entity to assume for it any other obligation or liability in connection with this product or **Limited Warranty**. This **Limited Warranty** does not apply and is not cumulative to any accessory or part distributed by Quadratec for which the Manufacturer provides a separate written warranty.

What is Covered: Subject to the terms, exclusions and limitations herein and with respect only to Quadratec branded accessories first sold in the United States, Quadratec warrants to the initial retail purchaser only that your Quadratec accessory shall be free of defects in material and workmanship: **for a period of three (3) years from date of retail purchase.**

This **Limited Warranty** is not assignable and shall terminate upon sale of the vehicle upon which the Quadratec accessory is installed or other transfer third persons.

All other warranties are hereby disclaimed, except to the extent prohibited by applicable law in which case any implied warranty of merchantability or fitness for a particular purpose on this product is limited to 3 year from date of initial retail sale. Quadratec reserves the rights to: (a.) require invoice or other proof your accessory is within the terms of this **Limited Warranty** as a condition of warranty service and, (b.) make future revisions to this product and **Limited Warranty** without prior notice or obligation to upgrade your product.

What is Not Covered:

Your Quadratec **Limited Warranty** does not cover products or parts Quadratec determines to have been damaged by or subjected to:

(a.) installation damage, alteration, modification, combination with other parts, failure to maintain or improper repair or service, (b.) normal wear & tear, cosmetic damage or damage from moisture or water immersion, (c.) Acts of God, accidents, misuse, negligence, inadequate mounting or impact with vehicle(s), obstacles or other aspects of the environment, (d.) theft, vandalism or other intentional damage.

Remedy Limited to Repair/Replacement:
The exclusive remedy provided hereunder shall, upon Quadratec inspection and at Quadratec's option, be either repair or replacement of product or parts (new or refurbished) covered under this Limited Warranty. Customers requesting warranty consideration should first contact Quadratec to obtain a RGA number (610-701-3336). All labor, removal, shipping and installation costs are customer's responsibility.

Other Limitations - Exclusion of Damages - Your Rights Under State Law:

In consideration of the purchase price paid, neither Quadratec nor any independent Quadratec distributor/licensee are responsible for any time loss, rental costs, or for any incidental, consequential, punitive or other damages you may have or incur in connection with any part or product purchased. Your exclusive remedy hereunder for covered parts is repair/replacement as described above.

This **Limited Warranty** gives you specific rights. You may also have other rights that vary from state to state. For example, some states do not allow limitations of how long an implied warranty lasts and /or do not allow the exclusion or limitation of incidental or consequential damages, so the limitations and exclusions herein may not apply to you.

©Quadratec, Inc. 2017. All Rights Reserved.

Part # 12999.9021



The Trusted Source